



VOLLEYBALL WORLD  
**BEACH  
PRO TOUR**

**2026 BEACH PRO TOUR ELITE  
GSTAAD**

**1-5 JULY 2026**

**EVENT PLAYBOOK**

## EVENT PLAYBOOK

### PRE-EVENT – BEFORE ARRIVAL

#### 1. Invitation Letter, Visa & Entry Documents

ITEM	DETAILS
Invitation Letter	<ul style="list-style-type: none"> <li>• Contact Person: <ul style="list-style-type: none"> <li>○ Name: Karin Spychiger</li> <li>○ Email: <a href="mailto:karin.spychiger@volleyball.ch">karin.spychiger@volleyball.ch</a></li> </ul> </li> <li>• It takes approximately 2 days to issue the Invitation Letter.</li> <li>• Information required for invitation letter: <ul style="list-style-type: none"> <li>○ First name &amp; last name</li> <li>○ Date of entry in Switzerland / Date of departure from Switzerland</li> <li>○ Role at event (i.e. Athlete, Coach, Official)</li> <li>○ Passport number</li> <li>○ Passport expiry date</li> <li>○ Passport copy</li> </ul> </li> </ul>
Visa	<ul style="list-style-type: none"> <li>• Participants are responsible for organizing their own Visa. See above information on the process to be followed to avoid issues upon arrival.</li> <li>• For more information see: <a href="https://www.eda.admin.ch/eda/en/fdfa/entry-switzerland-residence/visa-requirements-application-form.html">https://www.eda.admin.ch/eda/en/fdfa/entry-switzerland-residence/visa-requirements-application-form.html</a></li> </ul>
Entry Documents	<ul style="list-style-type: none"> <li>• Please note that it is the responsibility of each participant to check and issue their entry documents (e.g. VISA) on time to participate in the event.</li> </ul>
Medical Services and Procedures to be Followed	<ul style="list-style-type: none"> <li>• <b>Contact Person/Team:</b> <ul style="list-style-type: none"> <li>○ For any questions regarding medical protocol, please reach out to FIVB Medical department – <a href="mailto:medical@fivb.com">medical@fivb.com</a></li> </ul> </li> </ul>

## 2. Event Info

### Gstaad Promenade

Address	Promenade 76, 3780 Gstaad	
Website	beachgstaad.ch	
Distance from hotel Main Draw Men	1.4 km	15 min (walking)
Distance from hotel Main Draw Women	750m	9 min (walking)
Distance from training courts	1 km	12 min (walking)
Distance from airport	149 km	2h15 min (by car)

### VENUE LAYOUT

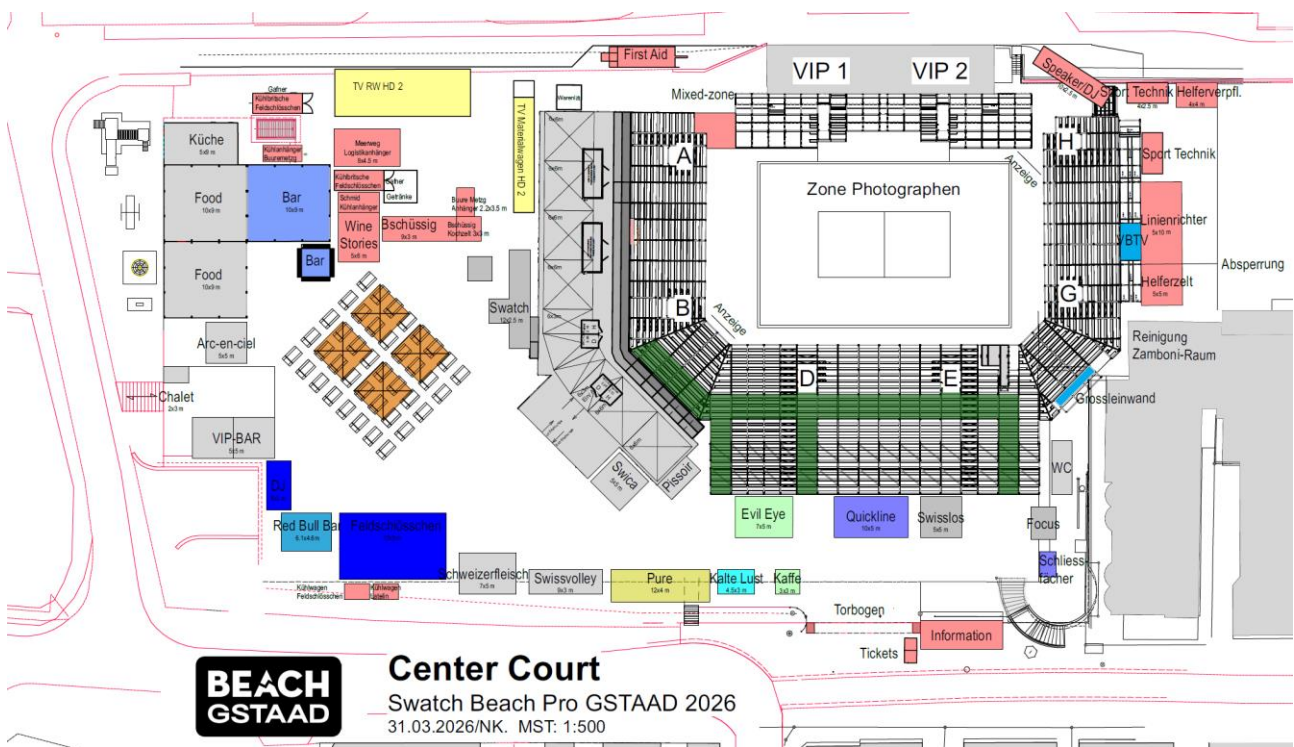

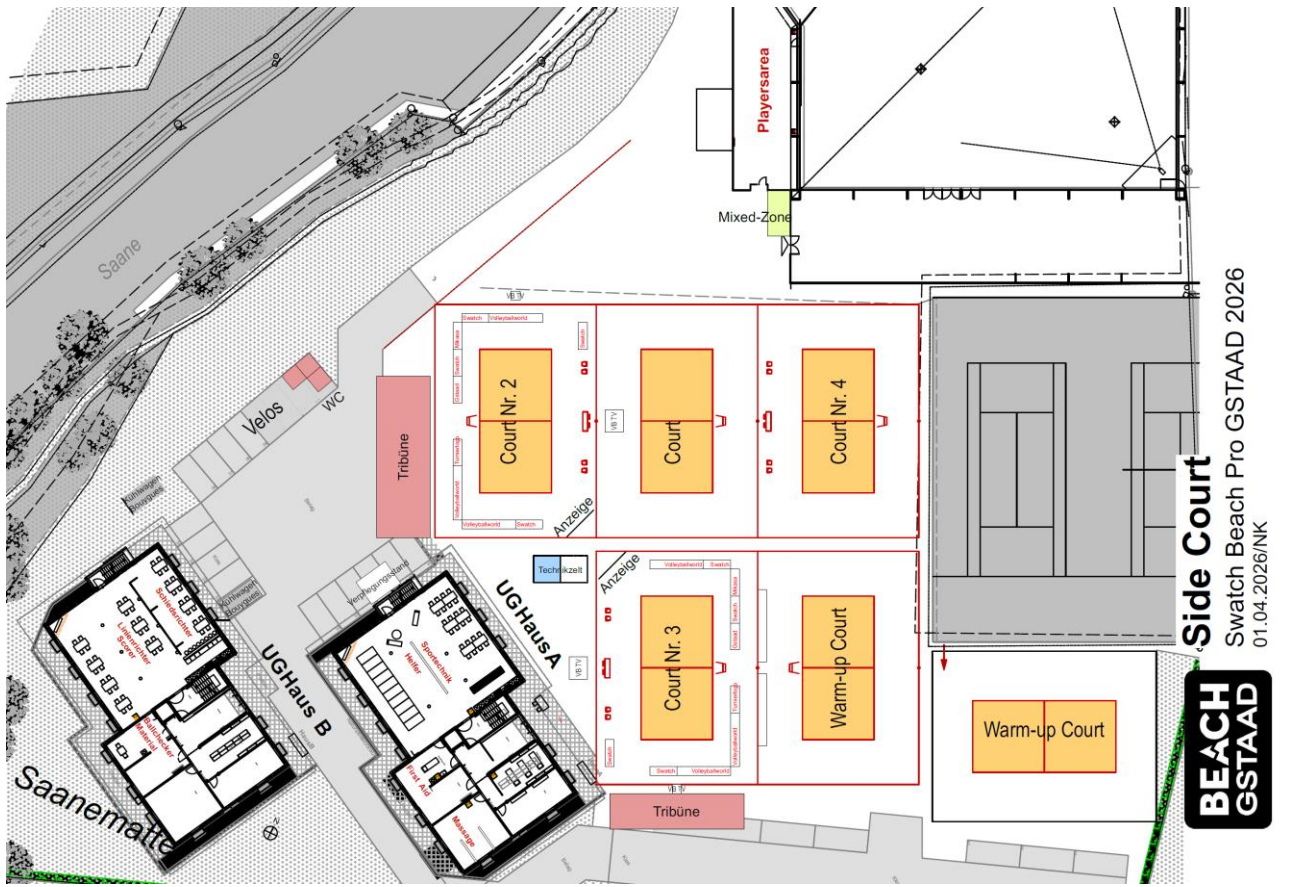

### Accommodation

- Hotel accommodation will be provided to the Main Draw teams by the organiser.
- Athletes will be personally responsible for all extras at the hotel such as mini-bar, phone calls, etc. including any damage incurred to the room. Payments must be made upon checkout.
- Organisers are not responsible for reservations for coaches, team physiotherapists, guests or family members accompanying the participating athletes.

Official Hotel 1 Main Draw Men	Name: Arc-en-ciel Website: <a href="http://arc-en-ciel.ch">arc-en-ciel.ch</a> Booking contact: Claudia Ferrigolo - <a href="mailto:info@arc-en-ciel.ch">info@arc-en-ciel.ch</a>
Official Hotel 2 Main Draw Women	Name: Gstaaderhof Website: <a href="http://gstaaderhof.ch">gstaaderhof.ch</a> Booking contact: Esther Saake - <a href="mailto:info@gstaaderhof.ch">info@gstaaderhof.ch</a>

- Athletes will only have a discounted rate until July 2<sup>nd</sup> in the two official main draw hotels. Please book directly with the contact person/email for each hotel.

#### Hotel Arc-en-ciel

- Booking: according to availability on the day of booking
- Room – CHF 260.00 / night (2 PAX)
- Breakfast – included
- Full board – CHF 75.00 per person per day
- Contact Person – Claudia Ferrigolo
- Email - [info@arc-en-ciel.ch](mailto:info@arc-en-ciel.ch)

#### Hotel Gstaaderhof

- Booking: according to availability on the day of booking
- Room – CHF 260.00 / night (2 PAX)
- Breakfast – included
- Full board – CHF 75.00 per person per day
- Contact Person – Esther Saake
- Email [info@gstaaderhof.ch](mailto:info@gstaaderhof.ch)

#### Athlete's Ticketing

In addition to the 2 tickets per athlete/day reaching the QFs, teams can request by email 2 accreditation passes, valid only for their specific matches before QFs played on Centre Court. Email must be sent with the names of the 2 friends or family members. An ID card will need to be presented as deposit to retrieve the accreditation. Passes must be returned just after the end of the match.

**Email: [sport@beachgstaad.ch](mailto:sport@beachgstaad.ch)**

## Transportation

- The official airports confirmed by the organiser is as follows:
  - **Airport: Geneva International Airport (GVA) (from Sunday 28 June, 9:00 am)**
  - **Airport: Zurich Airport (ZRH) (from Sunday, 28 June, 9:00 am)**
  - **Euroairport: Basel (BSL) (from Sunday 28 June, 9:00 am)**
- The organiser will provide transportation for main draw athletes only. This includes the following:
  - Geneva International Airport – Official Hotel – Geneva International Airport
  - Zurich Airport – Official Hotel – Zurich Airport
  - Basel Euroairport – Official Hotel – Basel Euroairport
  - Official hotel – Venue – Official Hotel
- **Contact Person/Team: [transportation@beachgstaad.ch](mailto:transportation@beachgstaad.ch)**

The travel information should be shared by each athlete with the organising Event Operations contact no later than **22/06/2026**. If this information is received after the deadline, the organiser has no obligation to provide transportation from the airport to the official hotel.

### **IMPORTANT**

**First Shuttle from the airports to Gstaad: Sunday, 28 June, 9:00 am**

**Last Shuttle from Gstaad to the airports: Monday, 6<sup>th</sup> July, 11:00 am**

## Accreditation

- Accreditation will be required by all athletes, FIVB officials, referees, VW staff, VIPs, media, technical staff, court personnel, volunteers, vendors, etc. by organisers, and will ensure that only those with appropriate accreditation can access the designated venue areas.
- **Coaches and Physiotherapists**
  - Accreditation forms for coaches and physiotherapists are available at the following link: <https://www.fivb.com/en/beachvolleyball/tools/forms>. All applicants must include a 3x4 cm portrait photo as part of their submission.
  - **Please note that a maximum of three (3) team members per team will be granted accreditation.**
  - **Deadline for team members accreditation request is on 17/06.**
- **Contact Person/Team: [sport@beachgstaad.ch](mailto:sport@beachgstaad.ch)**

### Catering

- Organiser will provide all three meals for athletes and referees, being breakfast, lunch and dinner at the official hotel. Meals will be arranged by the organiser from dinner the day before the event starts until breakfast the day after the team was eliminated from the event.

### Medical Services and Procedures

- During Competition & Training
  - During Competition & Training, there will be a first responders team at the venue (excluding Sunday 28/06).
  - Doping control may be conducted, therefore, athletes are highly recommended to keep their passports and official ids of the players with him/her.
- Out of Competition & Training
  - For Out of Competition & Training there will be the option to arrange a first aid treatment in the hotel. If more treatment is necessary, local organiser will provide a transportation where needed.
  - Teams and all participants are requested to follow the hygiene protocol posted by the FIVB Medical Department.
- Hospital will be chosen depending on the injury.
  - Emergency Services Number (Medical): 144
  - Emergency Services Number (Fire Department): 118
  - Emergency Services Number (Police): 117
- In the case of an emergency, organizer will provide first responders and transportation all the way to the hospital and back. The cost of treatment will be covered by the athlete concerned.
- Each individual athlete is obliged to have their own insurance as per FIVB Event Regulations – Chapter 17.

### Mixed Zones and Press Conferences

- Athletes are required to attend mixed zone interviews after each match, while still in competition uniform. The scheduling of press conferences will be communicated to athletes in advance. All athletes are required to attend the press conference(s), if requested.

### Uniforms

Playing tops/tanks will be provided to all athletes (Main Draw and Qualification) by the organiser. Shorts/bottoms and accessories are the responsibility of the players and/or their sponsors. **Please note that advertising for lottery and betting operators (with exception of Swiss operators is not allowed in Switzerland).** If required by the FIVB Technical Delegate, other uniforms and accessories will be checked during the Preliminary Inquiry. Athletes of the same team must wear the same colour and style of shorts. At the qualification tournament, one uniform per athlete will be provided.

### Team Video Service

- In collaboration with a service provider, Volleyball World will provide Team Video Services at all Challenge and Elite16 events. For the login information of the Team Video Service, please email the FIVB Beach Volleyball department – [beachvolleyball@fivb.com](mailto:beachvolleyball@fivb.com)

### Fitness Gym

Fitness Gym	<ul style="list-style-type: none"> <li>• Name: Fitness @ Ebnit: <b>Available from 29 to 3th July</b></li> <li>• Address: Rumpleregässli 6, 3780 Gstaad</li> <li>• Website: -</li> <li>• Opening hours: 09:00am-12:00pm / 03:00pm-05:00pm</li> <li>• Limited space, maximum of 4 athletes at the same time</li> <li>• Reservation: TBC</li> <li>• Rules: <ul style="list-style-type: none"> <li>- Please note that gym session reservations can be made no more than 24 hours in advance.</li> <li>- Only one reservation per athlete per day</li> <li>- 30' per athlete per day</li> <li>- Coaches/Physiotherapists are not allowed to train in this gym</li> </ul> </li> </ul>
	<ul style="list-style-type: none"> <li>• Name: Sportzentrum, Move It Fitness</li> <li>• Address: Sportzentrumstrasse 5, 3780 Gstaad</li> <li>• Website: <a href="https://www.sportzentrum-gstaad.ch/de/fitness/informationen">https://www.sportzentrum-gstaad.ch/de/fitness/informationen</a></li> <li>• Opening hours: 08:00am – 09:00pm (Monday – Friday) 08:30am – 07:00pm (Saturday/Sunday)</li> <li>• Cost: CHF 20/day</li> <li>• <b>Please Note: There is no shower option in “Move it Fitness” after the game at the Side Courts</b></li> </ul>

### Event Website and Social Media

Event Website	<ul style="list-style-type: none"> <li>• <a href="https://en.volleyballworld.com/beachvolleyball/competitions/beach-pro-tour/2026/elite16/gstaad-sui/">https://en.volleyballworld.com/beachvolleyball/competitions/beach-pro-tour/2026/elite16/gstaad-sui/</a></li> <li>• <a href="https://www.beachgstaad.ch/en">https://www.beachgstaad.ch/en</a></li> </ul>
Instagram/Facebook	<ul style="list-style-type: none"> <li>• Volleyball World (Beach) <ul style="list-style-type: none"> <li>○ @beachvolleyballworld</li> <li>○ @beachgstaad</li> </ul> </li> </ul>
YouTube	<ul style="list-style-type: none"> <li>• Volleyball World (Beach) <ul style="list-style-type: none"> <li>○ <a href="https://www.youtube.com/channel/UCHQUWveEpeO1KtkwbDn6jNA">https://www.youtube.com/channel/UCHQUWveEpeO1KtkwbDn6jNA</a></li> </ul> </li> <li>• Beach Gstaad <ul style="list-style-type: none"> <li>○ <a href="https://www.youtube.com/@swatchbeachprogstaad">https://www.youtube.com/@swatchbeachprogstaad</a></li> </ul> </li> </ul>
OTT Platform	<ul style="list-style-type: none"> <li>• Matches will be streamed on Volleyball World TV app or VolleyballWorld.tv</li> </ul>
Hashtags	<ul style="list-style-type: none"> <li>• Volleyball World (Beach) <ul style="list-style-type: none"> <li>○ #BeachProTour</li> <li>○ #BeachProTourGstaad</li> </ul> </li> <li>• Beach Gstaad <ul style="list-style-type: none"> <li>○ #beachgstaad #beachmeetsalps #thelaceto beach</li> </ul> </li> </ul>

## Contacts

Role	Name	Email Address
<b>Contacts</b>		
FIVB Technical Delegate	Christopher Schrenk	cs@tacora.at
FIVB Technical Delegate Assistant	Christian Schemeth	christian@schemeth.com
FIVB Referee Coach	Maria Amélia Villas-Bôas	mavboas57@gmail.com
FIVB Referee Coach Assistant	Ehad Tadres	ehab.nader@hotmail.com
VW Event Ops	N/A	gstaadeventops@volleyball.world
FIVB Medical department	N/A	medical@fivb.com
FIVB Beach Volleyball department	N/A	beachvolleyball@fivb.com

### 3. Competition

#### Preliminary Inquiry Requirements & Schedule

- Attendance to the Preliminary Enquiry and Technical Meeting (if required) is mandatory for both team athletes. Athletes must bring their uniform, including any headgear, armbands or other pieces of uniform intended to be used during matches for approval of the Technical Delegate. The detailed schedule is as follows:

Preliminary Inquiry	
Qualification and Main Draw	<ul style="list-style-type: none"> <li>• Date: 30/06/2026</li> <li>• Time: 13:30 - 17:00 (Both genders)</li> <li>• Location: Center Court / Info Point</li> </ul>

## Training

- **Please note that official training starts as from the 28/06.** On Sunday, 28/06, the Side Courts are available for unofficial training. LOC staff will be on the training courts to support but without medical staff. All training will still be managed by the online platform. Training session reservations can be made no more than 24 hours in advance. Each team is entitled to make one reservation per day (i.e. teams cannot reserve multiple training sessions for the week ahead). Additional training sessions may be possible only if the courts are available.
- **Athletes must register in the training booking platform at least 24 hours before the intended training session.**

Training Courts Address:	<ul style="list-style-type: none"> <li>• Side Courts: Sportzentrumstrasse 15</li> </ul>
Availability Date for Training:	<ul style="list-style-type: none"> <li>• 28/06/2026 - 01/07/2026</li> </ul>
Number of courts available for training:	<ul style="list-style-type: none"> <li>• 3 Competition Courts + 2 Warm-up Courts (total – 5)</li> </ul>
Competition Courts Address	<ul style="list-style-type: none"> <li>• Center Court: Promenade 76. 3780 Gstaad</li> <li>• Side Court: Sportzentrumstrasse 17, 3780 Gstaad</li> </ul>
Training Booking:	<ul style="list-style-type: none"> <li>• <a href="https://fivb.beachcourts.net">https://fivb.beachcourts.net</a> <a href="mailto:beachtraining@volleyball.world">beachtraining@volleyball.world</a> for any assistance with the booking tool.</li> </ul>

Training Courts Address:	<ul style="list-style-type: none"> <li>• Rumpleregässli 8, 3780 Gstaad</li> </ul>
Availability Date for Training:	<ul style="list-style-type: none"> <li>• 01/07/2026 – 03/07/2026</li> </ul>
Number of courts available for training:	<ul style="list-style-type: none"> <li>• 2 Training Courts</li> </ul>
Competition Courts Address	<ul style="list-style-type: none"> <li>• Center Court: Promenade 76. 3780 Gstaad</li> <li>• Side Court: Sportzentrumstrasse 17, 3780 Gstaad</li> </ul>
Training Booking:	<ul style="list-style-type: none"> <li>• <a href="https://fivb.beachcourts.net">https://fivb.beachcourts.net</a> <a href="mailto:beachtraining@volleyball.world">beachtraining@volleyball.world</a> for any assistance with the booking tool.</li> </ul>

## Competition Schedule

- The detailed match-up schedule will be confirmed after the completion of the preliminary inquiry (per gender tournament) following the results progressed



**Competition Schedule**  
**2026 BPT - Elite - Gstaad, Switzerland**  
**01 JULY - 05 JULY**

**Main Draw of 24 teams, Qualification of 16 teams**  
4 competition courts over 5 days.

**Qualification Tournament & Main Draw**

DATE	LOCAL TIME	UTC	COURT 1	COURT 2	Court 3	Court 4	PHASES
<b>Day 1 (Wed) 01.07.26</b>	09:00	07:00	M-QT-R16	M-QT-R16	M-QT-R16	M-QT-R16	Qualification (M & W)
	10:00	08:00	M-QT-R16	M-QT-R16	M-QT-R16	M-QT-R16	
	11:00	09:00	W-QT-R16	W-QT-R16	W-QT-R16	W-QT-R16	
	12:00	10:00	W-QT-R16	W-QT-R16	W-QT-R16	W-QT-R16	
	13:00	11:00	M Pool A R1	M Pool A R1	M Pool B R1	M Pool B R1	Main Draw Pool Play (M&W)
	14:00	12:00	M Pool C R1	M Pool C R1	M Pool D R1	M Pool D R1	
	15:00	13:00	M Pool E R1	M Pool E R1	M Pool F R1	M Pool F R1	
	16:00	14:00	W Pool A R1	W Pool A R1	W Pool B R1	W Pool B R1	
17:00	15:00	W Pool C R1	W Pool C R1	W Pool D R1	W Pool D R1		
18:00	16:00	W Pool E R1	W Pool E R1	W Pool F R1	W Pool F R1		

**Main Draw**

DATE	LOCAL TIME	UTC	COURT 1	COURT 2	Court 3	Court 4	PHASES
<b>Day 2 (Thu) 02.07.26</b>	09:00	07:00	M Pool A R2	M Pool A R2	M Pool B R2		Main Draw Pool Play (M&W)
	10:00	08:00	M Pool B R2	M Pool C R2	M Pool C R2		
	11:00	09:00	M Pool D R2	M Pool D R2	M Pool E R2		
	12:00	10:00	M Pool E R2	M Pool F R2	M Pool F R2		
	13:00	11:00	W Pool A R2	W Pool A R2	W Pool B R2		
	14:00	12:00	W Pool B R2	W Pool C R2	W Pool C R2		
	15:00	13:00	W Pool D R2	W Pool D R2	W Pool E R2		
	16:00	14:00	W Pool E R2	W Pool F R2	W Pool F R2		
	17:00	15:00	M Pool A R3	M Pool A R3	M Pool B R3		
	18:00	16:00	M Pool B R3	M Pool C R3	M Pool C R3		
19:00	17:00	M Pool D R3	M Pool D R3				

DATE	LOCAL TIME	UTC	COURT 1	COURT 2	Court 3	Court 4	PHASES
<b>Day 3 (Fri) 03.07.26</b>	09:00	07:00	M Pool E R3	M Pool E R3	M Pool F R3		Main Draw Pool Play (M&W)
	10:00	08:00	M Pool E R3	W Pool A R3	W Pool A R3		
	11:00	09:00	W Pool B R3	W Pool B R3	W Pool C R3		
	12:00	10:00	W Pool C R3	W Pool D R3	W Pool D R3		
	13:00	11:00	W Pool E R3	W Pool E R3			
	14:00	12:00	W Pool F R3	W Pool F R3	M LL #1		
	15:00	13:00	M LL #1				
	16:00	14:00	M R16 #1	M R16 #2	M R16 #3		
	17:00	15:00	M R16 #4	M R16 #5	M R16 #6		
	18:00	16:00	W LL #1	M R16 #7			
19:00	17:00	W LL #2	M R16 #8				

DATE	LOCAL TIME	UTC	COURT 1	COURT 2	Court 3	Court 4	PHASES
<b>Day 4 (Sat) 04.07.26</b>	10:00	08:00	W R16 #1	W R16 #2			Playoff - Round of 16 (W)
	11:00	09:00	W R16 #3	W R16 #4			
	12:00	10:00	W R16 #5	W R16 #6			
	13:00	11:00	W R16 #7	W R16 #8			
	14:00	12:00	M QF #1	M QF #2			Quarterfinals (M & W)
	15:00	13:00	M QF #3	M QF #4			
	16:00	14:00	M QF #1	M QF #2			
	17:00	15:00	M QF #3	M QF #4			
	18:00	16:00	M SF 1				Semifinals (M)
	19:00	17:00	M SF 2				

DATE	LOCAL TIME	UTC	COURT 1	COURT 2	Court 3	Court 4	PHASES
<b>Day 5 (Sun) 05.07.26</b>	10:00	08:00	W SF 1				Semifinals (W)
	11:00	09:00	W SF 2				
	<b>BREAK</b>						
	13:00	11:00	M-Bronze				Finals (M & W)
	14:00	12:00	W-Bronze				
	15:00	13:00	M-Gold				
	16:00	14:00	W-Gold				
	Followed by	Awarding					