



VOLLEYBALL WORLD
BEACH
PRO TOUR

2025 BEACH PRO TOUR – ELITE PLAYA DEL CARMEN

26 – 30 MARCH

EVENT PLAYBOOK

1. Invitation Letter, Visa & Entry Documents

ITEM	DETAILS
Invitation Letter	<p>Contact Person:</p> <ul style="list-style-type: none"> • Name: Abihail Rosales Márquez • Email: visas@mexbeachvolley.com.mx <p>It takes approximately 5 days to issue the Invitation Letter. Information required for invitation letter:</p> <ul style="list-style-type: none"> • Country of passport • Passport number • Current country of residence • Date of birth • Full name (as in passport) • Gender • Email/Phone number • Role at event (i.e. Athlete, Coach, Official) • Embassy that the VISA will be issued
Visa	<p>Participants are responsible for obtaining their own visa. Please follow the instructions provided by the local authority: (<u>LOCAL VISA APPLICATION AUTHORITY</u>)</p> <p>You can check if you require a visa in the link.</p>
Entry Documents	<p>Participants are responsible for checking and issuing their entry documents in time for the event. (<u>FIVB Documents</u>)</p>
Medical Procedures and Services	<p>For any questions regarding the Event Covid-19 Protocol, please reach out to FIVB Medical department: medical@fivb.com</p> <p>Please check with your airline if a PCR test is required to fly.</p>
Mandatory tax	<p>All foreigners over 15 years of age must pay a tax corresponding to \$224 Mexican pesos (\$11 USD) per person and will be charged before visitors leave Mexico.</p> <p>Payment can be made at the kiosks installed at the airport or through Visitax's official website (www.visitax.gob.mx/sitio/)</p>

2. Event Info

TEMPORAL STADIUM

Address	Portal Maya: Av. Benito Juarez #7, Col. Ejidal, Playa del Carmen, Q. Roo. C.P. 77712	
Website	N/A	
Distance from hotel	1.9 km (9 min by car)	
Distance from training courts	Same place	
Distance from airport	58.1 KM	56 mins drive

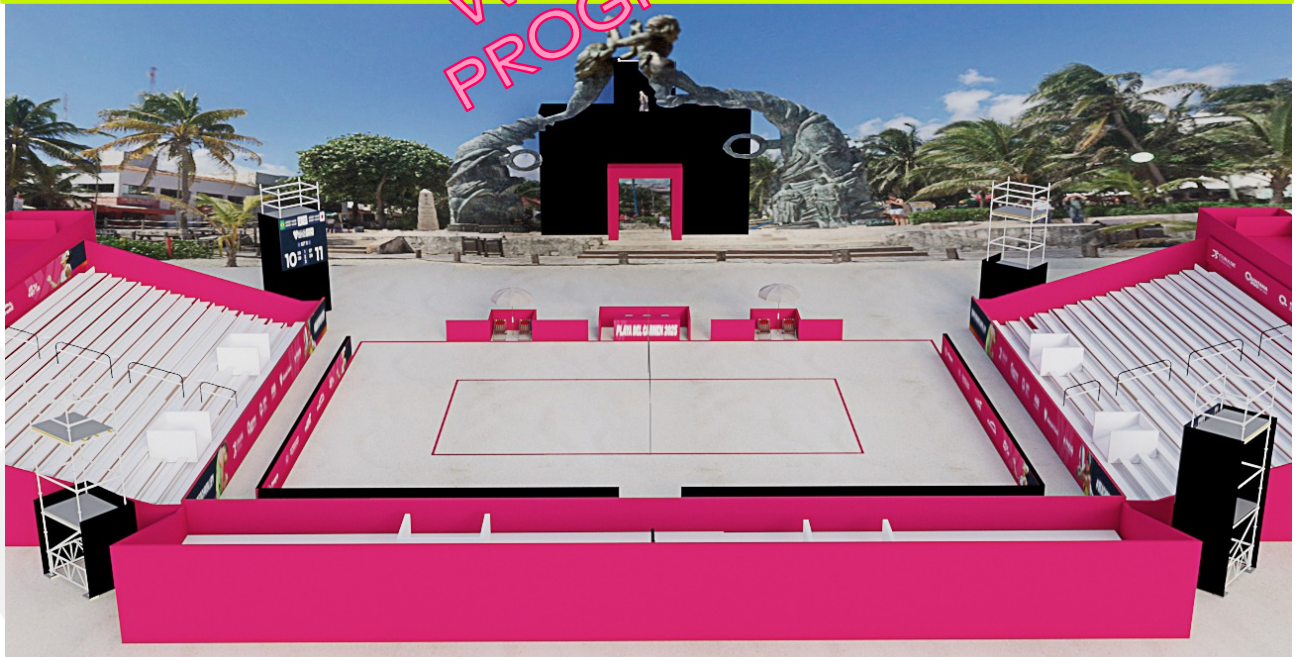
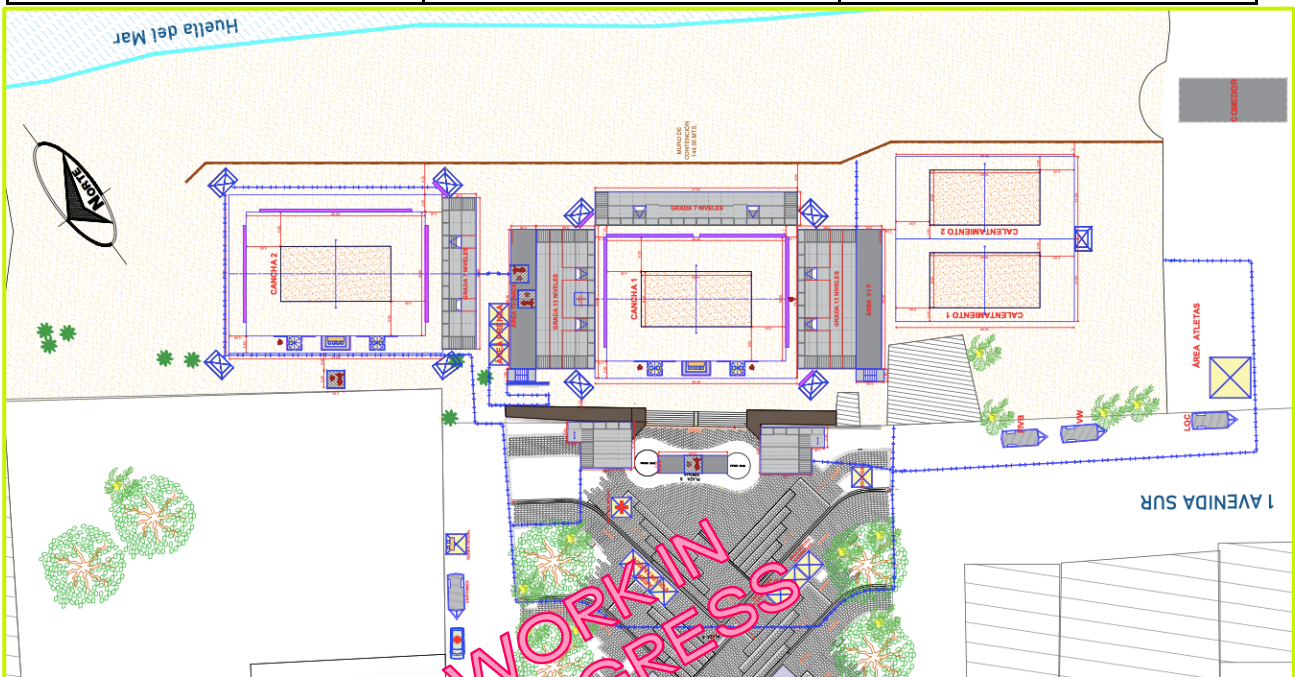

Accommodation

- Hotel accommodation will be provided to Main Draw teams by the Local Organiser.
- Athletes are personally responsible for all extras at the hotel such as mini-bar, phone calls, etc. including any damages incurred to the room. Payments must be made upon checkout.
- The Local Organiser is not responsible for reservations for coaches, team physiotherapists, guests or family members accompanying the participating athletes.

Official Hotel	ALOFT Website: Aloft
Other Hotel(s)	WYNDHAM GARDEN Website: Wyndham Garden
Other Hotel(s)	CITY EXPRESS SUITES BY MARRIOTT PLAYA DEL CARMEN Website: City Express

- Coaches, team physiotherapists, guests, friends and family can receive the following preferential rates by booking directly with the hotel.

<p>ALOFT (MD hotel) Single with breakfast = 150 usd. Code: Beach Pro Tour Elite 16 Playa del Carmen Reservation via email: dora.cruz@aimbridge.com cc: logistics@mexbeachvolley.com.mx</p>
<p>Wyndham Garden: (Official hotel). Single or double room with breakfast = 150 usd. Code: Beach Pro Tour Challenge Yucatan. Reservation via email: angela.hernandez@fibrainn.mx cc: logistics@mexbeachvolley.com.mx</p>
<p>City Express & City Express Suites Single or double room without breakfast = 140 usd. Code: Beach Pro Tour Elite 16 Playa del Carmen Reservation via email: cspdc.ventas1@norte19.com cc: logistics@mexbeachvolley.com.mx Reservation via WA: +52 984 128 8688</p>

These rates are subject to availability.

Transport

Official Airport: **CANCUN INTERNATIONAL AIRPORT– CUN**

The Local Organiser will provide transport for Main Draw athletes only. Transport includes:

- Airport – Official Hotel – Airport
- Official Hotel – Venue – Official Hotel

- Official Hotel – Training Venue – Official Hotel (if applicable)

Booking is required for airport transport. If you require airport transport, please send the following information to transportation@mexbeachvolley.com.mx

- Team name
- Flight number
- Flight schedule
- Number of people who require transport

TRANSFER YUCATÁN (Challenge) – PLAYA DEL CARMEN (Elite 16)

- Transfer Shuttle price 50USD (paid with cash or with credit card during the competition).
- Pick Up Location: Fiesta Inn Hotel at Mérida, Yucatán (March 24th, 10:00 am).
- Drop Off Location: Aloft Hotel at Playa del Carmen, Quintana Roo.
- Please fill out the [reservations form](#)

Deadline for airport transport requests: 1st march

If this information is received after the deadline, the Local Organiser has no obligation to provide airport transport.

Accreditation

Accreditation will be required by all athletes, FIVB officials, referees, VW staff, VIPs, media, technical staff, court personnel, volunteers, vendors, Local Organisers etc. and will ensure that only those with appropriate accreditation can access the designated venue areas.

Participants are responsible for sending their photographs for accreditation.

Coaches and Physiotherapists

Accreditation forms for coaches and physiotherapists are available at the following link: **[Athletes, Coaches and Physiotherapists Forms](#)**. All applicants must include a 3x4-cm portrait photo as part of their submission.

Please submit your accreditation form to the following email address:
info@mexbeachvolley.com.mx

Catering

The Local Organiser will provide all meals to Main Draw athletes and referees. Meals will start at dinner the day before Day 1 of Main Draw matches until breakfast the day after the team was eliminated from the event.

- Breakfast: 6:00 – 9:00 (Hotel)
- Lunch: 12:00 – 15:00 (TBC)
- Dinner: 19:00 – 22:00 (TBC)

Coaches and teams eliminated in the QT can purchase from food vendors at the venue or contact the Local Organiser for the catering rate card.

Please submit your catering request to the following email address:
logistics@mexbeachvolley.com.mx

Medical Services and Procedures

During Competition & Training

- During competition & training, first responders with an ambulance will be on standby at the venue.
- Doping control may be conducted, therefore, athletes are highly recommended to keep their passports and official IDs on their person.

Out of Competition & Training

- While out of competition & training, first aid treatment will be possible at the hotel. If more treatment is necessary, the Local Organiser will provide transport to an external facility (if required).
- The choice of hospital will be determined based on the severity of the injury.

Emergency Services Numbers:

- Medical & Fire Department: 911
- Police: 911

In the case of an emergency, the Local Organiser will provide medical first responders and transportation to the hospital and back. The cost of treatment will be covered by the athlete concerned. Each individual athlete is obliged to have their own insurance.

Mixed Zones and Press Conferences

Athletes are required to attend mixed zone interviews after each match, while still in competition uniform. The scheduling of press conferences will be communicated to

athletes in advance. All athletes are required to attend the press conference(s), if requested.

Uniforms

Playing tops/tanks will be provided to all athletes (Main Draw and Qualification) by the Local Organiser. Shorts/bottoms and accessories are the responsibility of the players and/or their sponsors. If required by the FIVB Technical Delegate, other uniforms and accessories will be checked during the Preliminary Inquiry. Athletes of the same team must wear the same colour and style of shorts.

Team Video Service

In collaboration with a service provider, Volleyball World will provide Team Video Services at all Challenge and Elite16 events. For the login information, please email the FIVB Beach Volleyball department at beachvolleyball@fivb.com.

Fitness Gym

MD Hotel	ALOFT Website: Aloft
----------	---

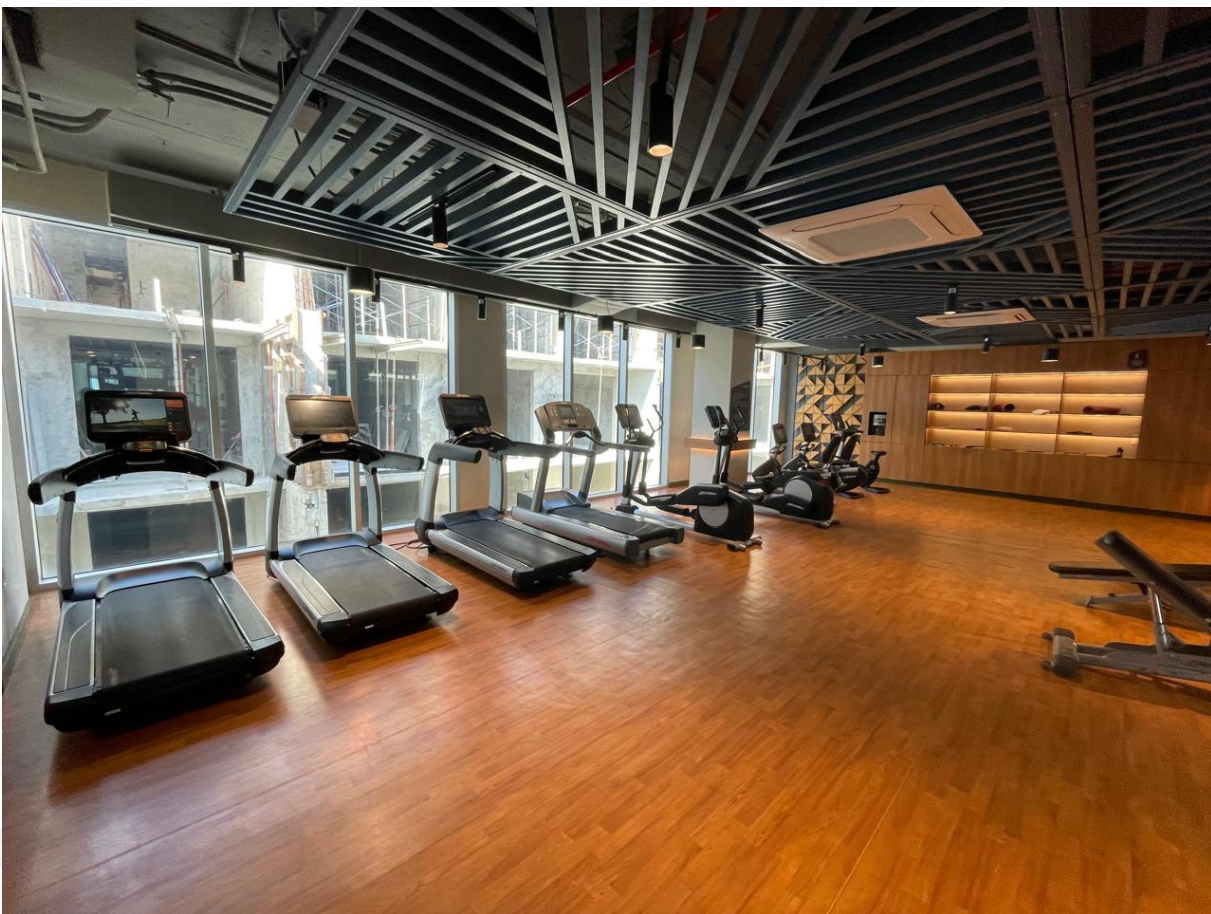

Event Website and Social Media

Event Website	https://en.volleyballworld.com/beachvolleyball/competitions/beach-pro-tour/2025/elite16/quintana-roo-mex/
Instagram/ Facebook	Volleyball World (Beach) @beachvolleyballworld Mex Beach Volley @Mexbeachvolley
YouTube	Beach Volleyball World https://www.youtube.com/c/BeachVolleyballWorld
OTT Platform	tv.volleyballworld.com
LOC Website	www.mexbeachvolley.com.mx
Hashtags	#BeachProTour #mexbeachvolley

Key Contacts

Role	Name	Email Address
FIVB Technical Delegate	Ed Drakich	ed.drakich@volleyball.ca
FIVB Referee Coach	José Casanova	jcasanovajcasanova@outlook.pt
VW Event Ops	N/A	quintanarooeventops@volleyball.world
FIVB Medical department	N/A	medical@fivb.com
FIVB Beach Volleyball department	N/A	beachvolleyball@fivb.com

3. Competition

Preliminary Inquiry Requirements & Schedule

Attendance to the Preliminary Enquiry is mandatory for both team athletes. Athletes must bring their uniform, including any headgear, armbands or other pieces of uniform intended to be used during matches for approval of the Technical Delegate. The detailed schedule is as follows:

Preliminary Inquiry	
Qualification + Main Draw Women	Date: 25th march Time: 15:00 – 17:30 Location: Competition Venue
Main Draw Men	Date: 26th march Time: 16:00 – 18:00 Location: Official Hotel (ALOFT) Note: Teams who qualify to Main Draw via the Qualification Tournament (including Lucky Losers) can also sign-in at the Competition Venue after completion of their respective matches.

Training

Days -3, -2, -1:

Training Court Address	Portal Maya: Av. Benito Juarez #7, Col. Ejidal, Playa del Carmen, Q. Roo. C.P. 77712
Start Date	March 23 th
Start Time	9:00 hrs – 17:00 hrs
Number of Courts	2 courts (1 women – 1 men)

Book your training session here: <https://fivb.beachcourts.net/>. For any assistance with the tool, please contact: beachtraining@volleyball.world.

Training session reservations can be made no more than 24 hours in advance. Each team is entitled to make one reservation per day (i.e. teams cannot reserve multiple training sessions for the week ahead). Additional training sessions may be possible only if the courts are available.

Competition Schedule

The detailed match schedule will be confirmed after the completion of the Preliminary Inquiry.

 Competition Schedule Elite24 (R18, R12, R6) Standard Template (5 days including 16 teams QT + 24 teams MD) 						
Qualification Tournament						
SESSION	DATE	TIME	GMT	COURT 1	Court 2	PHASES
1	Day 1 (Wed)	9:00	12:00	W-QT-R16	W-QT-R16	Qualification (W)
		9:50	12:50	W-QT-R16	W-QT-R16	
		10:40	13:40	W-QT-R16	W-QT-R16	
		11:30	14:30	W-QT-R16	W-QT-R16	
		12:30	15:30	M-QT-R16	M-QT-R16	Qualification (M)
		13:20	16:20	M-QT-R16	M-QT-R16	
		14:10	17:10	M-QT-R16	M-QT-R16	
		15:00	18:00	M-QT-R16	M-QT-R16	
		16:30	19:30	W-MD-Pool #1	W-MD-Pool #2	Main Draw Pool Play (W)
		17:30	20:30	W-MD-Pool #3	W-MD-Pool #4	
		18:30	21:30	W-MD-Pool #5	W-MD-Pool #6	
		19:30	22:30	W-MD-Pool #7	W-MD-Pool #8	
20:30	23:30	W-MD-Pool #9	W-MD-Pool #10			
21:30	0:30	W-MD-Pool #11	W-MD-Pool #12			
Main Draw						
SESSION	DATE	TIME	GMT	COURT 1	Court 2	PHASES
2	Day 2 (Thu)	9:00	12:00	M-MD-Pool #1	M-MD-Pool #2	Main Draw Pool Play (M)
		9:50	12:50	M-MD-Pool #3	M-MD-Pool #4	
		10:40	13:40	M-MD-Pool #5	M-MD-Pool #6	
		11:30	14:30	M-MD-Pool #7	M-MD-Pool #8	
		12:30	15:30	M-MD-Pool #9	M-MD-Pool #10	
		13:20	16:20	M-MD-Pool #11	M-MD-Pool #12	
3	Day 2 (Thu)	14:10	17:10	W-MD-Pool #13	W-MD-Pool #14	Main Draw Pool Play (W)
		15:00	18:00	W-MD-Pool #15	W-MD-Pool #16	
		16:00	19:00	W-MD-Pool #17	W-MD-Pool #18	
		17:00	20:00	W-MD-Pool #19	W-MD-Pool #20	
		18:00	21:00	W-MD-Pool #21	W-MD-Pool #22	
		19:00	22:00	W-MD-Pool #23	W-MD-Pool #24	
		20:00	23:00	M-MD-Pool #13	M-MD-Pool #14	Main Draw Pool Play (M) - winner round
		21:00	0:00	M-MD-Pool #15	M-MD-Pool #16	
		22:00	1:00	M-MD-Pool #17	M-MD-Pool #18	
SESSION	DATE	TIME	GMT	COURT 1	Court 2	PHASES
3	Day 3 (Fri)	9:00	12:00	M-MD-Pool #19	M-MD-Pool #20	Main Draw Pool Play (M) - loser round
		10:00	13:00	M-MD-Pool #21	M-MD-Pool #22	
		11:00	14:00	M-MD-Pool #23	M-MD-Pool #24	
		12:00	15:00	W-MD-R18 #1	W-MD-R18 #2	
		13:00	16:00	W-MD-R18 #3	W-MD-R18 #4	
4	Day 3 (Fri)	14:00	17:00	W-MD-R18 #5	W-MD-R18 #6	Main Draw R18 (W & M)
		16:00	19:00	M-MD-R18 #1	M-MD-R18 #2	
		17:00	20:00	M-MD-R18 #3	M-MD-R18 #4	
		18:00	21:00	M-MD-R18 #5	M-MD-R18 #6	Main Draw R12 (W)
		19:00	22:00	W R12 #1	W R12 #2	
		20:00	23:00	W R12 #3	W R12 #4	
21:00	0:00	W R12 #5	W R12 #6			
SESSION	DATE	TIME	GMT	COURT 1	Court 2	PHASES
5	Day 4 (Sat)	10:00	13:00	M R12 #1	M R12 #2	Main Draw R12 (M)
		11:00	14:00	M R12 #3	M R12 #4	
		12:00	15:00	M R12 #5	M R12 #6	
6	Day 4 (Sat)	14:00	17:00	W QF #1	W QF #2	R6 (W & M)
		15:00	18:00	W QF #3	W QF #4	
		16:00	19:00	M QF #1	M QF #2	
		17:00	20:00	M QF #3	M QF #4	
7	Day 4 (Sat)	BREAK				Semi Finals (W)
		19:00	22:00	W SF 1		
20:00	23:00	W SF 2				
SESSION	DATE	TIME	GMT	COURT 1	Court 2	PHASES
8	Day 5 (Sun)	11:00	14:00	M SF 1		Semi Finals (M)
		12:00	15:00	M SF 2		
		13:00	16:00	W-Bronze		Finals (M & W)
		14:00	17:00	W-Gold		
		15:00	18:00	M-Bronze		
		16:00	19:00	M-Gold		
		Followed by			Awarding	