



**Beach Volleyball  
World Championships**

**TLAXCALA 2023**



2023 BEACH WORLD CHAMPS  
TLAXCALA

6-15 October

EVENT PLAYBOOK

## EVENT PLAYBOOK

### PRE-EVENT – BEFORE ARRIVAL

#### 1. Invitation Letter, Visa & Entry Documents

|                                                       |                                                                                                                                                                                                                                                                                                                                                                                                                                                                                                                                                                                                                                                                                                                                                                            |
|-------------------------------------------------------|----------------------------------------------------------------------------------------------------------------------------------------------------------------------------------------------------------------------------------------------------------------------------------------------------------------------------------------------------------------------------------------------------------------------------------------------------------------------------------------------------------------------------------------------------------------------------------------------------------------------------------------------------------------------------------------------------------------------------------------------------------------------------|
| <p>Invitation Letter</p>                              | <ul style="list-style-type: none"> <li>● Contact Person: <ul style="list-style-type: none"> <li>○ Name: Francisco Sanchez</li> <li>○ Email: <a href="mailto:visas@mundialtlaxcala2023.com">visas@mundialtlaxcala2023.com</a></li> </ul> </li> <li>● It takes approximately 2 days to issue the invitation letter.</li> <li>● Information and/or documents required for invitation letter: <ul style="list-style-type: none"> <li>○ Full name (as in passport)</li> <li>○ Role at event (i.e., Athlete, Coach, Official)</li> <li>○ Gender</li> <li>○ Date of birth (dd/mm/yy)</li> <li>○ Passport number</li> <li>○ Passport issue date (dd/mm/yy)</li> <li>○ Passport expiry date (dd/mm/yy)</li> <li>○ Nationality</li> <li>○ Full passport image</li> </ul> </li> </ul> |
| <p>Visa</p>                                           | <ul style="list-style-type: none"> <li>● Participants are responsible for organizing their own Visa. See above information on the process to be followed to avoid issues upon arrival.</li> <li>● For more information see: <a href="https://www.gob.mx/gobierno/mexico-en-el-mundo">https://www.gob.mx/gobierno/mexico-en-el-mundo</a></li> </ul>                                                                                                                                                                                                                                                                                                                                                                                                                         |
| <p>Entry Documents</p>                                | <ul style="list-style-type: none"> <li>● Please note that it is the responsibility of each participant to check and issue their entry documents (e.g., VISA) on time to participate in the event.</li> </ul>                                                                                                                                                                                                                                                                                                                                                                                                                                                                                                                                                               |
| <p>Medical Services and Procedures to be Followed</p> | <ul style="list-style-type: none"> <li>● Please note that as per the FIVB Medical department, no more specific Event Covid-19 regulation will be developed, unless required by the host country.</li> <li>● <b>Contact Person/Team:</b> <ul style="list-style-type: none"> <li>○ For any questions regarding the Event Covid-19 Protocol, please reach out to FIVB Medical department – <a href="mailto:medical@fivb.com">medical@fivb.com</a></li> </ul> </li> </ul>                                                                                                                                                                                                                                                                                                      |

## 2. Event Info

### Tlaxcala

|                               |                                                                 |                                                 |
|-------------------------------|-----------------------------------------------------------------|-------------------------------------------------|
| Address Tlaxcala Bullring     | Av Independencia, Centro, 90000 Tlaxcala de Xicohténcatl, Tlax. |                                                 |
| Location                      | <a href="#">Venue Google Maps location</a>                      |                                                 |
| Address MAT Stadium           | Plaza de la Constitución, Tlaxcala de Xicohténcatl, Tlax.       |                                                 |
| Location                      | <a href="#">Venue Google Maps location</a>                      |                                                 |
| Distance from hotel           | 300m/15m                                                        | 4 min (walk) / 1min (walk)                      |
| Distance from training courts | 1.2 km                                                          | Driving Time: 10 min<br>Walking distance: 15min |
| Distance from airport         | 115 km                                                          | 2h (drive)                                      |
| Competition courts            | 2 competition courts (MAT Stadium and Tlaxcala Bullring)        |                                                 |
| Warm up courts                | 2 warm up courts (Downtown)                                     |                                                 |



## Apizaco

|                               |                                                             |                |
|-------------------------------|-------------------------------------------------------------|----------------|
| Address “El Pana” bullring    | Prolongacion 16 de Septiembre S/n, El Carmen, 90300 Apizaco |                |
| Location                      | <a href="#">Venue Google Maps location</a>                  |                |
| Distance from hotel           | 7.9 km                                                      | 12 min (drive) |
| Distance from training courts | 8.3 km                                                      | 10 min (drive) |
| Distance from airport         | 115 km                                                      | 2h (drive)     |
| Competition court             | 1 competition court (“El Pana” bullring)                    |                |
| Warm up court                 | 1 warm up court (same venue as competition court)           |                |

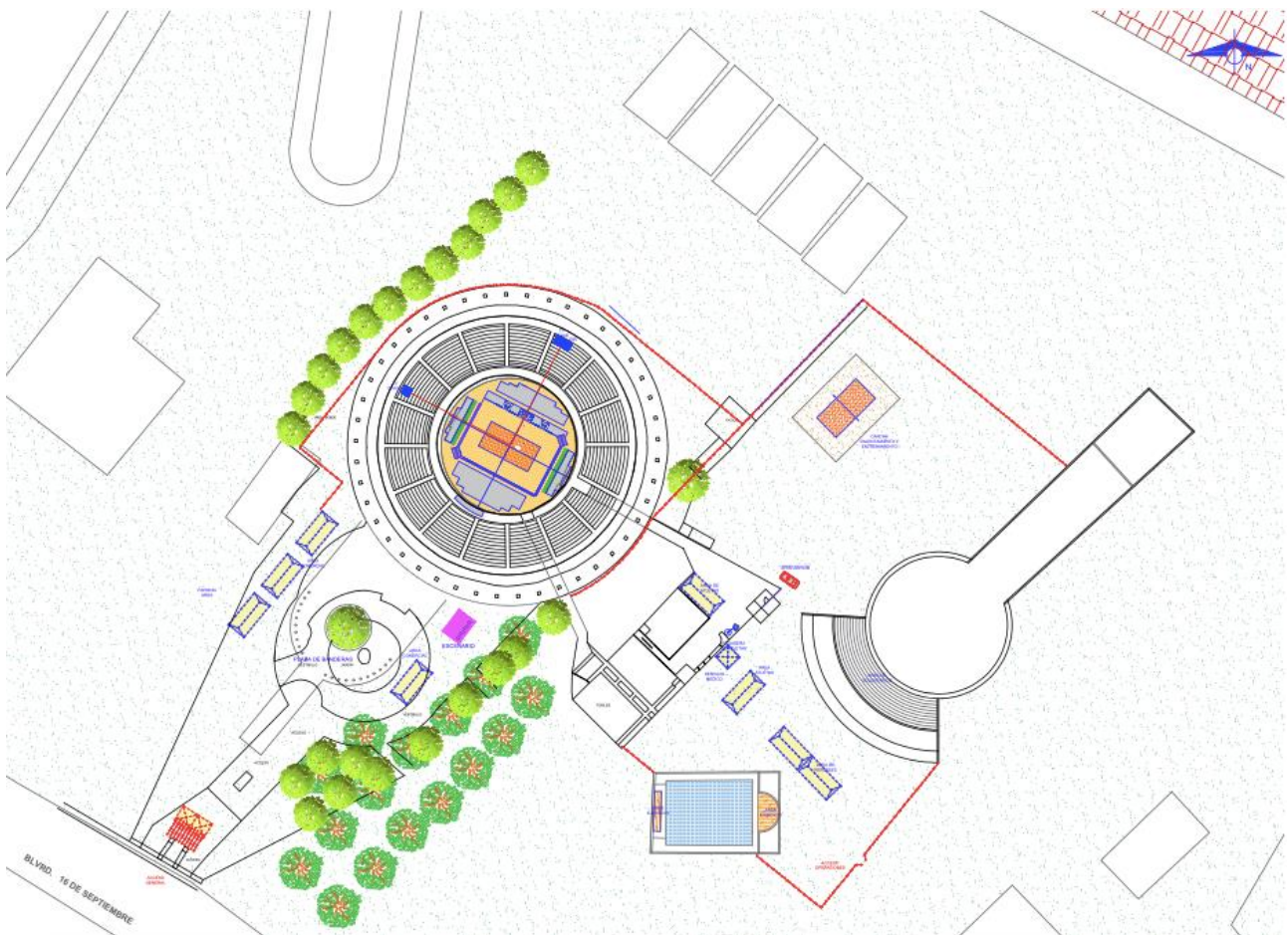

## Huamantla

|                               |                                                   |                |
|-------------------------------|---------------------------------------------------|----------------|
| Address “La Taurina” bullring | Gabriel Lima 205A, Centro, 90501 Huamantla, Tlax. |                |
| Location                      | <a href="#">Venue Google Maps location</a>        |                |
| Distance from hotel           | 8.5km                                             | 10 min (drive) |
| Distance from training courts | 3.5 km                                            | 12 min (drive) |
| Distance from airport         | 115 km                                            | 2h (drive)     |
| Competition court             | 1 competition court (“La Taurina” bullring)       |                |
| Warm up court                 | 1 warm up court (same venue as competition court) |                |

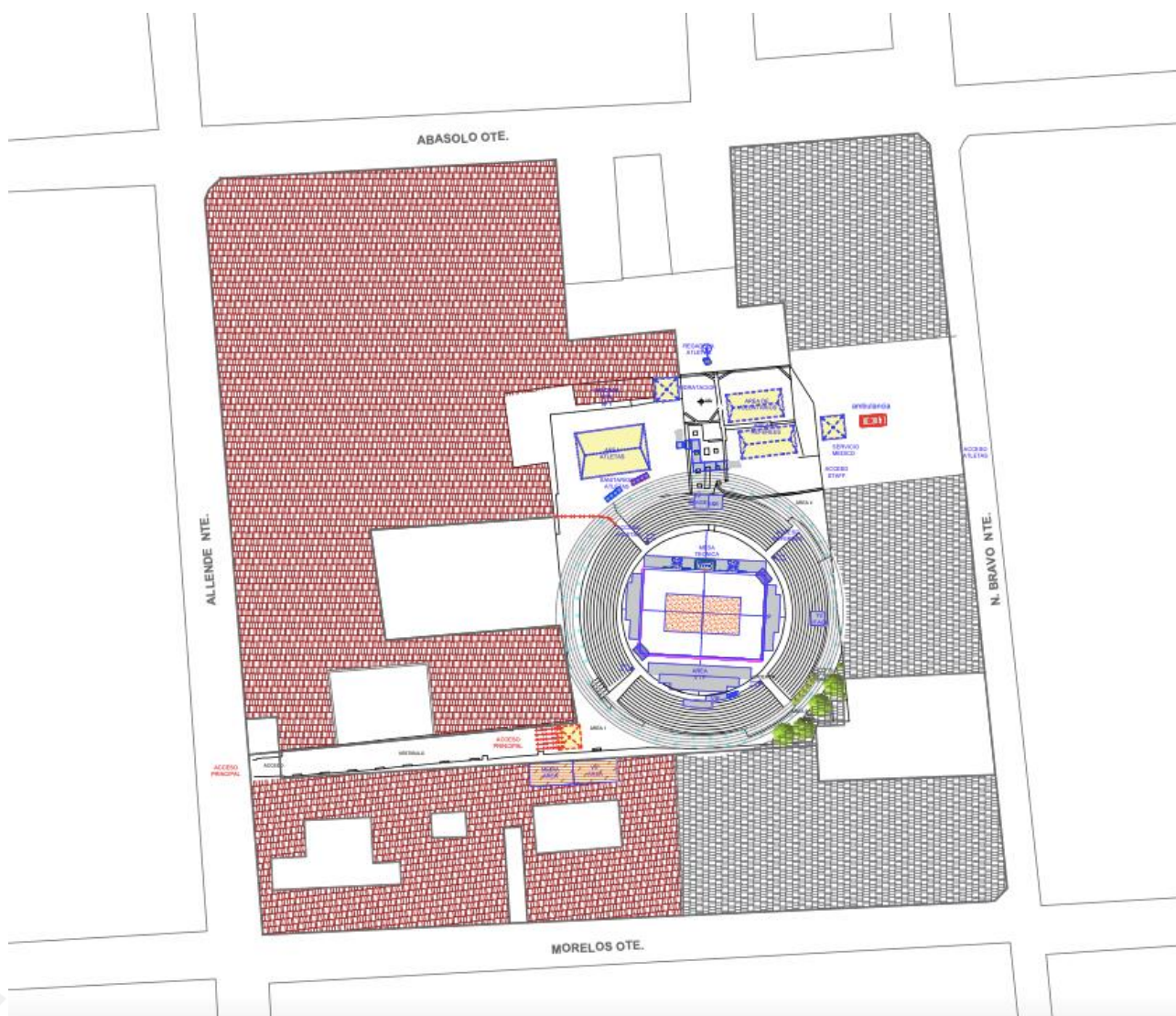

## Accommodation

- Hotel accommodation will be provided to the Main Draw teams by the organiser.
- Athletes will be personally responsible for all extras at the hotel such as mini-bar, phone calls, etc. including any damage incurred to the room. Payments must be made upon checkout.
- Organisers are not responsible for reservations for coaches, team physiotherapists, guests or family members accompanying the participating athletes.

|                                         |                                                                                                                                                                                                                                   |
|-----------------------------------------|-----------------------------------------------------------------------------------------------------------------------------------------------------------------------------------------------------------------------------------|
| <p>Tlaxcala</p> <p>Official Hotel:</p>  | <p>San Francisco Hotel</p> <p>Website: <a href="https://www.hotelsanfranciscotlaxcala.com/">https://www.hotelsanfranciscotlaxcala.com/</a></p> <p>Booking contact: Yuridiana Torres<br/>accommodation@mundialtlaxcala2023.com</p> |
| <p>Tlaxcala</p> <p>Other Hotels:</p>    | <p>La Loma Hotel</p> <p>Booking contact: Yuridiana Torres<br/>accommodation@mundialtlaxcala2023.com</p>                                                                                                                           |
| <p>Apizaco</p> <p>Official Hotel:</p>   | <p>Holiday Inn Hotel</p> <p>Website: <a href="#">Holiday Inn Hotel</a></p> <p>Booking contact: Yuridiana Torres<br/>accommodation@mundialtlaxcala2023.com</p>                                                                     |
| <p>Huamantla</p> <p>Official Hotel:</p> | <p>Hacienda Soltepec</p> <p>Website: <a href="https://www.haciendasoltepec.com/">https://www.haciendasoltepec.com/</a></p> <p>Booking contact: Yuridiana Torres<br/>accommodation@mundialtlaxcala2023.com</p>                     |

- Coaching staff, friends and family will have access to a discounted rate for all suggest event hotels, depending on the availability of rooms in particular San Francisco Hotel. For further information, please contact:
  - Email – [logisticstlaxcala2023@gmail.com](mailto:logisticstlaxcala2023@gmail.com)

## Transportation

- The official airport confirmed by the organiser is as follows:
  - **Airport: Mexico City's Benito Juarez International Airport (AICM)**
- The organiser will provide transportation for main draw athletes only. This will include.
  - Mexico City International Airport – Official hotel – Mexico City International Airport
- **Transportation will be provided to athletes and up to 3 team members per team, free of charge. If airport pickup is required, please contact the local organiser no later than 15/09/2023 (email follows below).** If this information is received after the deadline, the organiser has no obligation to provide transportation from the airport to the official hotel. **Please communicate your itinerary, any changes or delays in real time to this email: [transport@mundialtlaxcala2023.com](mailto:transport@mundialtlaxcala2023.com)**
- **If additional team members require transportation, this must be communicated before the above-mentioned deadline and a rate card for it will be established.**

## Accreditation

- Accreditation will be required by all athletes, FIVB officials, referees, VW staff, VIPs, media, technical staff, court personnel, volunteers, vendors, etc. by organisers, and will ensure that only those with appropriate accreditation can access the designated venue areas.
  
- **Coaches and Physiotherapists**
  - Accreditation forms for coaches and physiotherapists are available at the following link: <https://www.fivb.com/en/beachvolleyball/tools/forms>. All applicants must include a 3x4 cm portrait photo as part of their submission.
  
  - The organizing committee will grant up to 3 team staff accreditations free of charge per team. If teams require a greater number of accreditations, it must pay for each extra accreditation an amount of 100USD, this fee will provide the transportation service.
  
  - **Deadline for submission of accreditation requests of team members is on 15/09/2023.**
  
- **Contact Person/Team:** Abihail Rosales - [abihail@moveo-lab.com](mailto:abihail@moveo-lab.com)

## **VALIDATION OF ACCREDITATIONS**

1. All accreditations will be valid for the areas and access zones that are printed on it, in a period from September 23<sup>rd</sup> to October 13<sup>th</sup>, 2023
2. Accreditations must have a special hologram for the Semifinal and final phase that will be granted at the Tlaxcala operational center.
3. If the accreditation does not have the hologram, it will not be valid.
4. Only the teams qualified to SF and F will receive this hologram.

## Catering

- Organiser will provide all three meals for athletes and referees, being breakfast at the official hotel, lunch, and dinner at the competition venue. Meals will be arranged by the organiser from dinner the day before the event starts until breakfast the day after the team was eliminated from the event.
  
- The meals for coaches will have a cost for \$20 USD per person per meal per day, please see the availability per city with Ms Yuridiana Torres at [accommodation@mundialtlaxcala2023.com](mailto:accommodation@mundialtlaxcala2023.com)

## Medical Services and Procedures

- During Competition & Training
  - During Competition & Training, there will be a first responders with an ambulance will be on standby at the venue.
  - Doping control may be conducted; therefore, athletes are highly recommended to keep their passports and official ids of the players with him/her.
- Out of Competition & Training
  - For Out of Competition & Training there will be the option to arrange a first aid treatment in the hotel. If more treatment is necessary, local organiser will provide a transportation where needed.
  - Teams and all participants are requested to follow the hygiene protocol posted by the FIVB Medical Department. It is no longer mandatory to keep the face masks at this time.
- Hospital will be chosen depending on the injury.
  - Emergency Services Number (Medical & Fire Department): 911
  - Emergency Services Number (Police): 911
- In the case of an emergency, organizer will provide first responders and transportation all the way to the hospital and back. The cost of treatment will be covered by the athlete concerned.
- Each individual athlete is obliged to have their own insurance as per FIVB Event Regulations – Chapter 17.

## Mixed Zones and Press Conferences

- Athletes are required to attend mixed zone interviews after each match, while still in competition uniform. The scheduling of press conferences will be communicated to athletes in advance. All athletes are required to attend the press conference(s), if requested.

## Team Video Service

- In collaboration with a service provider, Volleyball World will provide Team Video Services at the 2023 Beach World Champs. For the login information of the Team Video Service, please email the FIVB Beach Volleyball department – [beachvolleyball@fivb.com](mailto:beachvolleyball@fivb.com)



## Fitness Gym

Fitness gyms are located in athlete's hotel at respective host cities and can be used free of charge. In addition to the hotel gyms, two extra gyms are also provided in Tlaxcala as below.

| Location             | Date                 | Distance to the hotel | Driving time                                   |
|----------------------|----------------------|-----------------------|------------------------------------------------|
| Eros Gym             | 3 to 16 October 2023 | 290 m                 | Walking distance: 4min                         |
| Divana Training Club | 3 to 16 October 2023 | 2.4 km                | Driving Time: 9 min<br>Walking distance: 30min |

To book training sessions at the gym, you must use the online booking system (similar to training on the courts).

The schedules and services available will be as follows:

| Location             | Time          | Area                | Capacity         |
|----------------------|---------------|---------------------|------------------|
| Eros Gym             | 9:00 – 19:00  | Gym                 | 5 teams per hour |
| Eros Gym             | 10:00 – 18:00 | Functional training | 4 teams per hour |
| Divana Training Club | 9:00 – 19:00  | Gym                 | 5 teams per hour |
| Divana Training Club | 10:00 – 15:00 | Swimming pool       | 5 teams per hour |
| Divana Training Club | 10:00 – 18:00 | Functional training | 6 teams per hour |

## 3. Competition

### Preliminary Inquiry Requirements & Schedule

- Attendance to the Preliminary Inquiry and Technical Meeting (if required) is mandatory for both team athletes. **Athletes must bring their competition uniform, including any headgear, armbands or other pieces of uniform intended to be used during matches for approval of the Technical Delegate.** The detailed schedule is as follows:

| Preliminary Inquiry |                                                                                                                                                              |
|---------------------|--------------------------------------------------------------------------------------------------------------------------------------------------------------|
| Main Draw           | Date: 3 October 2023<br>Time: 09:00 – 13:00 & 15:00 – 19:00                                                                                                  |
|                     | Date: 4 October 2023<br>Time: 09:00 – 13:00 & 15:00 – 19:00                                                                                                  |
|                     | Date: 5 October 2023<br>Time: 09:00 – 13:00                                                                                                                  |
|                     | Location:<br>TLAXCALA: San Francisco Hotel - Pool area<br>APIZACO: Holiday Inn Hotel - Meeting room n°1<br>HUAMANTLA: Soltepec Hotel - Pedro Armendariz room |

## Training

- **Please note that training courts will be available as from the 23/09 but official training starts as from the 01/10.** Training session reservations can be made no more than 24 hours in advance. Each team is entitled to make one reservation per day (i.e., teams cannot reserve multiple training sessions for the week ahead). Additional training sessions may be possible only if the courts are available.
- **Athletes must register in the training booking platform at least 24 hours before the intended training session.**

|                                                      |                                                                                                                                                                                                                                                                                                                                      |
|------------------------------------------------------|--------------------------------------------------------------------------------------------------------------------------------------------------------------------------------------------------------------------------------------------------------------------------------------------------------------------------------------|
| Training courts address:                             | <ul style="list-style-type: none"> <li>• Tlaxcala: Heroico Colegio Militar 5, Centro, 90000 Tlaxcala</li> <li>• Apizaco: Prolongacion 16 de Septiembre S/n, El Carmen, 90300 Apizaco</li> <li>• Huamantla: Santa María Yancuitalpan, 90505 Huamantla</li> </ul>                                                                      |
| Availability date for training:                      | <ul style="list-style-type: none"> <li>• As from 23/09</li> </ul>                                                                                                                                                                                                                                                                    |
| Number of training courts available:                 | <ul style="list-style-type: none"> <li>• Tlaxcala: 2 training courts</li> <li>• Apizaco: 1 training court</li> <li>• Huamantla: 1 training court</li> </ul>                                                                                                                                                                          |
| Competition courts address                           | <ul style="list-style-type: none"> <li>• Tlaxcala (Bullring): Av Independencia, Centro, 90000 Tlaxcala</li> <li>• Tlaxcala (MAT Stadium): Centro, 90000 Tlaxcala</li> <li>• Apizaco : Prolongacion 16 de Septiembre S/n, El Carmen, 90300 Apizaco</li> <li>• Huamantla: Gabriel Lima 205A, Centro, 90501 Huamantla, Tlax.</li> </ul> |
| Availability date of competition courts for training | <ul style="list-style-type: none"> <li>• As from 04/10</li> </ul>                                                                                                                                                                                                                                                                    |
| Training Booking:                                    | <ul style="list-style-type: none"> <li>• <a href="https://fivb.beachcourts.net">https://fivb.beachcourts.net</a><br/><a href="mailto:beachtraining@volleyball.world">beachtraining@volleyball.world</a> for any assistance with the booking tool.</li> </ul>                                                                         |

## Ticketing

Athlete's friends and family will have access to 15% discount on the purchase of tickets for the event.

- Ticket website: <https://boletomovil.com/beach-volleyball-world-championships>
- Group: friends and family of participating athletes
- Promo Valid date: 31st August 2023 to 10th September 2023
- Contact for questions: [tickets@mundialtlaxcala2023.com](mailto:tickets@mundialtlaxcala2023.com)

## Competition Schedule

- The detailed match-up schedule will be confirmed after the completion of the preliminary inquiry (per gender tournament) following the results progressed.

| Date                                                             | Start Time  | Tlaxcala Bullring | Tlaxcala Townhall | Apizaco Bullring | Humantla Bullring |
|------------------------------------------------------------------|-------------|-------------------|-------------------|------------------|-------------------|
| Day 1 (Friday)                                                   |             |                   |                   |                  |                   |
|                                                                  |             |                   |                   |                  |                   |
|                                                                  |             |                   |                   |                  |                   |
|                                                                  | 14:30       | M Pool - R1       | M Pool - R1       | M Pool - R1      | M Pool - R1       |
|                                                                  | 15:30       | M Pool - R1       | M Pool - R1       | M Pool - R1      | M Pool - R1       |
|                                                                  | 16:30       | W Pool - R1       | W Pool - R1       | W Pool - R1      | W Pool - R1       |
|                                                                  |             |                   |                   |                  |                   |
|                                                                  | 19:00       | M Pool - R1       | M Pool - R1       | M Pool - R1      | M Pool - R1       |
|                                                                  | 20:00       | M Pool - R1       | M Pool - R1       | M Pool - R1      | M Pool - R1       |
|                                                                  | 21:00       | W Pool - R1       | W Pool - R1       | W Pool - R1      | W Pool - R1       |
| Date                                                             | Start Time  | Tlaxcala Bullring | Tlaxcala Townhall | Apizaco Bullring | Humantla Bullring |
| Day 2 (Saturday)                                                 | 09:00       | W Pool - R1       | W Pool - R1       | W Pool - R1      | W Pool - R1       |
|                                                                  | 10:00       | W Pool - R1       | W Pool - R1       | W Pool - R1      | W Pool - R1       |
|                                                                  | 11:00       | M Pool - R1       | M Pool - R1       | M Pool - R1      | M Pool - R1       |
|                                                                  | 12:00       | M Pool - R1       | M Pool - R1       | M Pool - R1      | M Pool - R1       |
|                                                                  |             |                   |                   |                  |                   |
|                                                                  | 14:30       | W Pool - R1       | W Pool - R1       | W Pool - R1      | W Pool - R1       |
|                                                                  | 15:30       | W Pool - R1       | W Pool - R1       | W Pool - R1      | W Pool - R1       |
|                                                                  | 16:30       | M Pool - R2       | M Pool - R2       | M Pool - R2      | M Pool - R2       |
|                                                                  |             |                   |                   |                  |                   |
|                                                                  | 19:00       | W Pool - R2       | W Pool - R2       | W Pool - R2      | W Pool - R2       |
| 20:00                                                            | W Pool - R2 | W Pool - R2       | W Pool - R2       | W Pool - R2      |                   |
| 21:00                                                            | M Pool - R2 | M Pool - R2       | M Pool - R2       | M Pool - R2      |                   |
| Date                                                             | Start Time  | Tlaxcala Bullring | Tlaxcala Townhall | Apizaco Bullring | Humantla Bullring |
| Day 3 (Sunday)                                                   | 09:00       | M Pool - R2       | M Pool - R2       | M Pool - R2      | M Pool - R2       |
|                                                                  | 10:00       | M Pool - R2       | M Pool - R2       | M Pool - R2      | M Pool - R2       |
|                                                                  | 11:00       | W Pool - R2       | W Pool - R2       | W Pool - R2      | W Pool - R2       |
|                                                                  | 12:00       | W Pool - R2       | W Pool - R2       | W Pool - R2      | W Pool - R2       |
|                                                                  |             |                   |                   |                  |                   |
|                                                                  | 14:30       | W Pool - R2       | W Pool - R2       | W Pool - R2      | W Pool - R2       |
|                                                                  | 15:30       | W Pool - R2       | W Pool - R2       | W Pool - R2      | W Pool - R2       |
|                                                                  | 16:30       | M Pool - R2       | M Pool - R2       | M Pool - R2      | M Pool - R2       |
|                                                                  |             |                   |                   |                  |                   |
|                                                                  | 19:00       | M Pool - R3       | M Pool - R3       | M Pool - R3      | M Pool - R3       |
| 20:00                                                            | M Pool - R2 | M Pool - R2       | M Pool - R2       | M Pool - R2      |                   |
| 21:00                                                            | W Pool - R3 | W Pool - R3       | W Pool - R3       | W Pool - R3      |                   |
| Date                                                             | Start Time  | Tlaxcala Bullring | Tlaxcala Townhall | Apizaco Bullring | Humantla Bullring |
| Day 4 (Monday)                                                   | 09:00       | W Pool - R3       | W Pool - R3       | W Pool - R3      | W Pool - R3       |
|                                                                  | 10:00       | W Pool - R3       | W Pool - R3       | W Pool - R3      | W Pool - R3       |
|                                                                  | 11:00       | M Pool - R3       | M Pool - R3       | M Pool - R3      | M Pool - R3       |
|                                                                  | 12:00       | M Pool - R3       | M Pool - R3       | M Pool - R3      | M Pool - R3       |
|                                                                  |             |                   |                   |                  |                   |
|                                                                  | 14:30       | M Pool - R3       | M Pool - R3       | M Pool - R3      | M Pool - R3       |
|                                                                  | 15:30       | M Pool - R3       | M Pool - R3       | M Pool - R3      | M Pool - R3       |
|                                                                  | 16:30       | W Pool - R3       | W Pool - R3       | W Pool - R3      | W Pool - R3       |
|                                                                  |             |                   |                   |                  |                   |
|                                                                  | 19:00       | W Pool - R3       | W Pool - R3       | W Pool - R3      | W Pool - R3       |
| 20:00                                                            | W Pool - R3 | W Pool - R3       | W Pool - R3       | W Pool - R3      |                   |
| 21:00                                                            | M Pool - R3 | M Pool - R3       | M Pool - R3       | M Pool - R3      |                   |
| <b>Womens Draw for R32 at 21:30, Men's Draw for R32 at 22:30</b> |             |                   |                   |                  |                   |

| Date            | Start Time | Tlaxcala Bullring                               | Tlaxcala Townhall | Apizaco Bullring | Humantla Bullring |
|-----------------|------------|-------------------------------------------------|-------------------|------------------|-------------------|
| Day 5 (Tuesday) | 13:00      |                                                 | W-LL 1            | W-LL3            |                   |
|                 | 14:00      |                                                 | W-LL 2            | W-LL4            |                   |
|                 | 15:00      |                                                 | M-LL 1            | M-LL 3           |                   |
|                 | 16:00      |                                                 | M-LL 2            | M-LL 4           |                   |
|                 |            | Drawing of lots to seed LL winners Women at TBC |                   |                  |                   |
|                 |            | Drawing of lots to seed LL winners Women at TBC |                   |                  |                   |

| Date              | Start Time | Tlaxcala Bullring | Tlaxcala Townhall | Apizaco Bullring | Humantla Bullring |
|-------------------|------------|-------------------|-------------------|------------------|-------------------|
| Day 6 (Wednesday) | 11:00      | W R32             | W R32             | M R32            | M R32             |
|                   | 12:00      | W R32             | W R32             | M R32            | M R32             |
|                   | 13:00      | M R32             | M R32             | W R32            | W R32             |
|                   | 14:00      | M R32             | M R32             | W R32            | W R32             |
|                   |            |                   |                   |                  |                   |
|                   | 17:00      | M R32             | M R32             | W R32            | W R32             |
|                   | 18:00      | M R32             | M R32             | W R32            | W R32             |
|                   | 19:00      | W R32             | W R32             | M R32            | M R32             |
| 20:00             | W R32      | W R32             | M R32             | M R32            |                   |

| Date             | Start Time | Tlaxcala Bullring | Tlaxcala Townhall | Apizaco Bullring | Humantla Bullring |
|------------------|------------|-------------------|-------------------|------------------|-------------------|
| Day 7 (Thursday) | 17:00      | M-R16             | M-R16             | W-R16            | W-R16             |
|                  | 18:00      | W-R16             | W-R16             | M-R16            | M-R16             |
|                  | 19:00      | W-R16             | W-R16             | M-R16            | M-R16             |
|                  | 20:00      | M-R16             | M-R16             | W-R16            | W-R16             |

| Date           | Start Time | Tlaxcala Bullring | Tlaxcala Townhall | Apizaco Bullring | Humantla Bullring |
|----------------|------------|-------------------|-------------------|------------------|-------------------|
| Day 8 (Friday) | 16:00      |                   | M-QF 2            |                  |                   |
|                | 17:00      |                   | W-QF 2            |                  |                   |
|                | 18:00      | M-QF 1            |                   | M-QF 3           |                   |
|                | 19:00      | W-QF 1            |                   | W-QF 3           |                   |
|                | 20:00      |                   |                   |                  | M-QF 4            |
|                | 21:00      |                   |                   |                  | W-QF 4            |

| Date             | Start Time | Tlaxcala Bullring | Tlaxcala Townhall | Apizaco Bullring | M Matches: 2<br>W Matches: 2 |
|------------------|------------|-------------------|-------------------|------------------|------------------------------|
| Day 9 (Saturday) |            |                   |                   |                  |                              |
|                  |            |                   |                   |                  |                              |
|                  |            |                   |                   |                  |                              |
|                  | 17:00      | M-SF1             |                   |                  |                              |
|                  | 18:00      | W-SF 1            |                   |                  |                              |
|                  |            |                   |                   |                  |                              |
|                  | 19:00      | M-SF 2            |                   |                  |                              |
|                  | 20:00      | W-SF 2            |                   |                  |                              |

| Date            | Start Time | Tlaxcala Bullring | Tlaxcala Townhall | Apizaco Bullring | M Matches: 2<br>W Matches: 2 |
|-----------------|------------|-------------------|-------------------|------------------|------------------------------|
| Day 10 (Sunday) |            |                   |                   |                  |                              |
|                 |            |                   |                   |                  |                              |
|                 |            |                   |                   |                  |                              |
|                 |            |                   |                   |                  |                              |
|                 |            |                   |                   |                  |                              |
|                 | 12:00      | M - Bronze        |                   |                  |                              |
|                 | 13:15      | W- Bronze         |                   |                  |                              |
|                 |            |                   |                   |                  |                              |
|                 | 14:30      | M - Gold          |                   |                  |                              |
|                 | 16:00      | W - Gold          |                   |                  |                              |
|                 | after      | Awarding          |                   |                  |                              |